

Instruction Manual

Solar Heating Panel

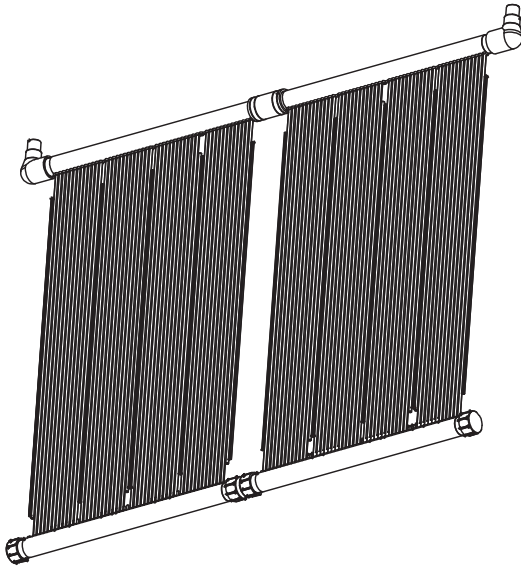

#70611

**Read the instruction manual carefully before assembly and use.
Please also save it for future reference.**

Contents

1、 Product Introduction.....	1
2、 Warning and Cautions.....	3
3、 Assembly and Operation Instruction.....	4
4、 Trouble Shooting.....	6
5、 Specifications.....	8
6、 Product Explosion Diagram and List of Accessories.....	8

1. Production Introduction:

The solar heating panel is a pool solar heating device to be connected to the pool filtration system. The solar heating panel heats the pool water by absorbing sunlight. Please refer to the below image for the water flow direction while in use. The water flows out of the swimming pool, enters the filtration system, and flows into the solar heating plate to flow inside the product. The solar heating panel absorbs the heat of the sun, thereby heating the internal water flow, and then the water flows out of the solar heating panel and returns to the pool to heat the pool water temperature.

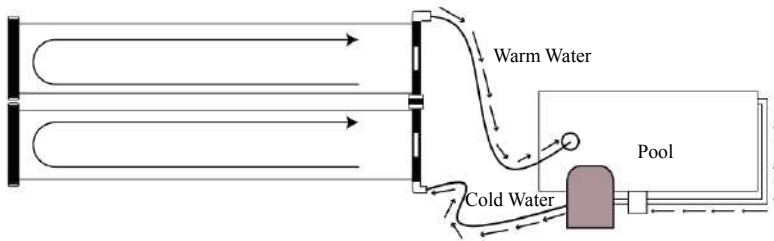

- The pool pump circulates the Water through the collectors.
- The collectors absorb the heat from the sun
- Warm water is returned to the pool

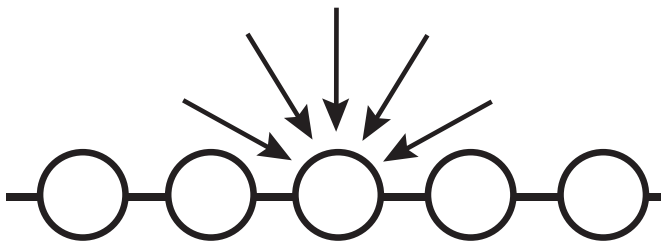

Solar Heating Panel Cross Section

The panel has a web construction designed form maximum heat absorption regardless of the position of the sun

2、 Warning and Cautions

1. Read this manual carefully and use it in strict accordance with the operating procedures of this manual. Otherwise, it may cause personal injury!
2. Children are not allowed to operate solar heating panel.
3. Solar heating panels are required to be installed on the ground and are not allowed to be installed on roofs or vertical structures.
4. It is strictly forbidden to step on the solar heating panel.

Note

1. The solar heating panel should be installed on a hard, level ground.
2. It is recommended that the installation site receive at least 6 hours of direct sunlight per day.
3. Adjust the aluminum feet to tilt the surface of the product toward the sun.
4. Always turn off the filtration system when installing, operating, or servicing the solar heating panel.
5. Install the solar heating panel far enough away from the swimming pool to prevent children from swimming with it.
6. When loosening the filter, pump or other connections, make sure the filter hose is closed or blocked.
7. All connecting hoses should be kept open to ensure that the hose does not become severely kinked or bent.
8. Make sure all hoses are tightly connected. If the hose leaks, check to make sure all parts with O-rings are connected and tightened.
9. Remarks: You can cover the pool cover at night to help maintain the water temperature in the pool.

3、 Assembly and Operation Instruction

1. Remove the solar heating panel and its accessories from the box.

Note:Laying the panel in the reverse direction of the coils will help flatten the panels

2. Remove and discard the black protective caps covering the threaded portion of the headers

3. Join the headers with the white labels together using a rubber hose connector and two 11/2" hose clamps. position the Hose clamps 1/2" in from each end of rubber connector hose and tightens.



4. Install the PVC elbow connectors on either end of that header near the label side.



5. Install the PVC end caps on rest of the headers.



6. Plug return fitting in pool to ensure no water loss when disconnecting hose from return.



7. Make sure filter is turned off so no water flows out of the filter when disconnecting return hose from the swimming pool return and connecting to the solar heater.



8. Secure flex hose to the top PVC elbow and return fitting of the pool using the stainless steel hose clamps.



9. Remove the plug from return fitting and turn on the valve for the filtration system, and make sure water flow is freely in all the piping.

Concatenation:

Multiple solar heating panels can be installed in series for larger pools and/or faster heating.

Winter:

In the winter, empty the water in the solar heating panel, and store the products in a warm and dry place for future use.

4. Trouble Shooting

Symptom	Possible Reasons and Corrective action
Seems the solar heating panel is not heating the pool water	<ul style="list-style-type: none"> ● Check the water flow of the pool backflow; make sure water go through the solar heating panel. ● Check the weather, if it is a cloudy or rainy day. ● Use a pool cover in night time will help maintain the water temperature and reduce heat loss.
Water from the solar heating panel do not back to the pool	<ul style="list-style-type: none"> ● Check whether all connectors are properly connected. ● Check whether the filtration valve is closed

<p>Bubble continue to appear in the pool during the water intake</p>	<ul style="list-style-type: none"> ● Check whether there is leakage for all of the connections ● Check water flow; make sure all the unions are properly connected. ● Check whether there is leakage or block for the flexible hoses
<p>There is water leakage for the connection of the solar heating panel</p>	<p>Check all the unions to see whether they are properly connected. Make sure all the stainless steel clamps for the flexible hoses are tighten enough.</p>

Solar Heating Panel Repair

If a solar heating panel develops a leak

Your solar heating panels are warranted against defects in materials and workmanship(see warranty for details and limitations)

If a leak develops for any other reason,you may use the repair method shown,The panels are not warranted against freeze damage.

Solar Heating Panel Repair

This method allows for on easy and permanent,in-site repair of a collector by isolating the leading riser tube.Referring to the figure of the right,locate the tube to be isolated.(End tube has been shown for clarity).Using a sharp utility knife,very carefully cut away approximately 1"(2.54cm)of the tube at both headers.Drive a #10 sheet metal screw,preferably stainless,into the hole in the header.The screw must be between 1/2"(1.27cm)and 3/4"(1.9cm)long.DO NOT OVER-TIGHTEN!

If the screw strips out,or if the repair leaks use a#12 screw.This repair method will not void the collector warranty.

With proper care and winterization,you will enjoy your solar heating panels for many years.

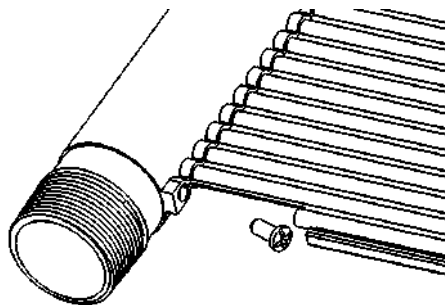

5. Specifications:

No.	Item	Specification
1	Volume capacity for each panel	around 20L(2x10L)
2	Max. working pressure	50PSI
3	Connection hose size	1-1/2" hose
5	Carton size	400*410*690MM
6	Gross weight	13.4KG
7	Products Size	6000*700*60MM

6. Product Explosion Diagram and List of Accessories

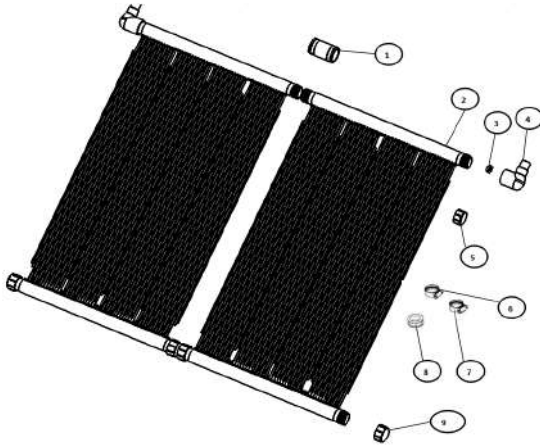

NO.	Part No.	Description	Qty
1	5434038080	rubber hose connector	1
2	647061171000	solar heating panel	2
3	47061106080	sealing gasket	1
4	47061103001	PVC elbow	2
5	47061102080	soft cap	4
6	5021004000	1-1/2" stainless steel clamp	2
7	5021007000	2-1/4" stainless steel clamp	4
8	5757001001	Teflon tape	1
9	47061101001	PVC end cap	4

